

ROUND FRAMELESS CEILING SPEAKER

- 20W 100V LOUDSPEAKER
- SIZE 8.0" (200MM)
- ELEGANT DESIGN
- QUICK MOUNT
- SUITABLE FOR PUBLIC ADDRESS AND BACKGROUND MUSIC BROADCASTS
- EXCELLENT SOUND QUALITY



OVERVIEW

The SPCR-20W-80 is an elegant 20W 100V round frameless ceiling mount loudspeaker, which has an 8" (200mm) full-range chassis providing excellent sound quality with both speech and background music. The speaker is fitted with a 100V transformer which has four power adjustment tapings of 20W, 15W, 10W, and 5W.

The SPCR-20W-80 speaker has a powder coated metal chassis and grille, with the high quality finish giving good long-term protection and resistance to corrosion. The speaker is supplied with a rear fire dome, and its enclosure is ingress protection rated to a minimum of IP21C.

As standard the speaker is coloured to match RAL9016 'Traffic White', however the speakers can be supplied in any four-digit RAL or NCS colour, as a special order.

Terminal connections are supplied at the rear of the speaker and easy ceiling mounting is provided through the use of spring clamps, which have protective caps for vibration damping.

The 100V loudspeaker line cabling is fed through rubber grommets in the firedome and then connected to the speaker connector terminals. For additional reliability, the speaker chassis is treated so that it is damp-resistant.

Please note that although very thin ceilings can be used as a mounting surface, with a possible ceiling thickness of between 1mm and 45mm, it should be ensured that the ceiling material's thickness and strength are appropriate to the weight of the speaker, and to the thickness and weight of the 100V line cables.

Enhanced Acoustic Simulator for Engineers (EASE) data is available for this speaker on request.

PRODUCT ATTRIBUTES

Power Tappings	20W / 15W / 10W / 5W
Impedance (100V)	500 / 667 / 1000 / 2000 Ohms
Frequency Response	100 - 20,000 Hz
SPL 1W / 1m, peak (IEC 60268-5)	105.6 dB
SPL 1W / 4m, peak (IEC 60268-5)	93.6 dB
SPL Pmax / 4m, peak (IEC 60268-5)	106.6 dB
Sensitivity 1W / 1m at 1kHz (IEC 60268-5)	97.8 dB
Dispersion (-6dB, 500Hz)	180°
Dispersion (-6dB, 1KHz)	155°
Dispersion (-6dB, 2KHz)	100°
Dispersion (-6dB, 4KHz)	60°
Temperature Range	-10 / +55 °C
Dimensions	265 x 115 mm
Ceiling Cut-Out Diameter	246 - 252 mm
Weight (net)	1.60 kg
Colour	RAL9016 'Traffic White'
Connector	Screw Terminals
Mounting	Quick-Fit Clamps
Ingress Protection (EN 60529) IP Rating (minimum)	IP21C
Maximum cable cross section	4 mm ²
Maximum cable cross section loop	4 mm ²
Packing Unit	8

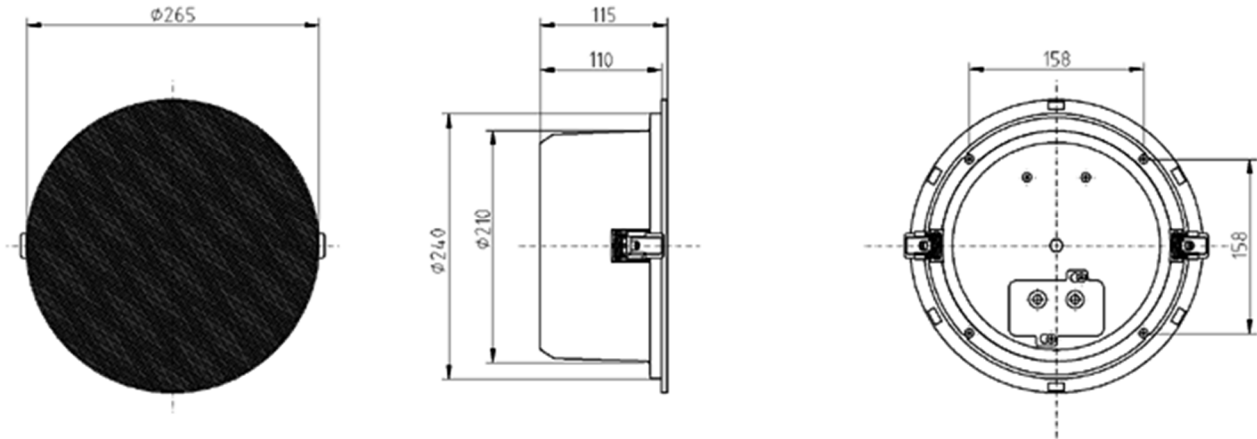
DIMENSIONAL DIAGRAM

This equipment is designed and manufactured to conform to the following EU Directives:

Electromagnetic Compatibility (EMC):	2014/30/EU
Low Voltage:	2014/35/EU
Restriction of Hazardous Substances (RoHS):	2011/65/EU & 2015/863/EU

Manufacturer

Application Solutions (Safety and Security) Limited
 Unit 17 - Cliffe Industrial Estate - Lewes - East Sussex - BN8 6JL - U.K.
 Tel: +44(0)1273 405411

www.asl-control.co.uk

All rights reserved.

Information contained in this document is believed to be accurate, however no representation or warranty is given and Application Solutions (Safety and Security) Limited assumes no liability with respect to the accuracy of such information.



Assessed to ISO 9001
LPCB Cert No: C1043